

# HYBRID STEPPING MOTOR SPECIFICATION

DIMENSIONS unit=mm

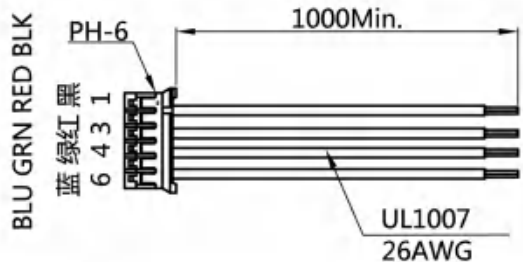

## Wiring Diagram

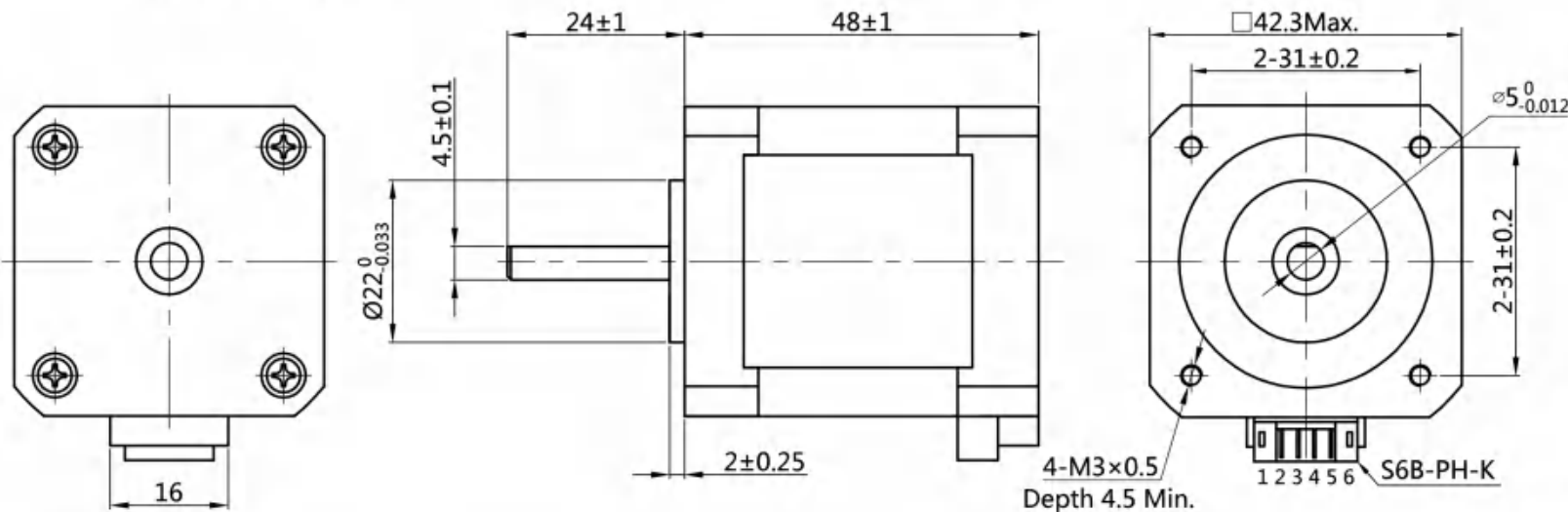
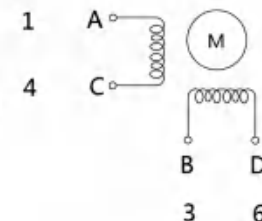

## Exciting Sequence vs. Direction of Rotation

STEP	A	B	C	D	
1	+	+	-	-	↑ CCW ↓ CW
2	-	+	+	-	
3	-	-	+	+	
4	+	-	-	+	

Clockwise view from mounting side

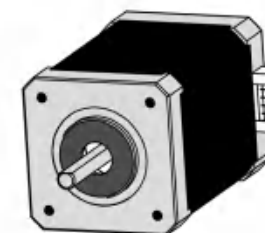

1. Number of Phase	2				
2. Step Angle	1.8° deg.				
3. Rated Voltage	2.8 V				
4. Rated Current/Phase	1.68 A ( 峰值 Peak Value )				
5. Phase Resistance	1.65 Ω±0.1(20°C)				
6. Phase Inductance	2.8 mH±20%(1kHz 1V RMS)				
7. Holding Torque	5.0 kg.cm				
8. Insulation Class	B ( 130° ) ;温升 80K Max.				
9. Weight	0.34 kg				
<b>Specifications</b>		<b>Comment</b>			

REV.	REVISION RECORD	DATE
DESIGN	成兆茹 2020.6.30	
STANDARD		
TECHNOLOGY		
CHECK		
APPROVE		

Changzhou BesFoc Motor Co., Ltd  
www.besfoc.com

**Specification**

TITLE	STEPPING MOTOR			
DWG.NO.	BF42HS48-1684-08AF			
MATERIAL	ECN SIGN	※	SIZE	A4
REV.	A	SCALE	1:2	SHEET 1 of 1